

# Product Data Sheet

## DX54012

GW FIT Range



Straight and revolving coupling device for sheath with IP54 protection degree.

|           |               |               |      |
|-----------|---------------|---------------|------|
| Colour    | Grey RAL 7035 | IP degree     | IP54 |
| ISO pitch | M 16x1.5      | Sheath Ø (mm) | 12   |
| Type      | Revolving     | Electrocod    | 210  |

### DIMENSIONAL

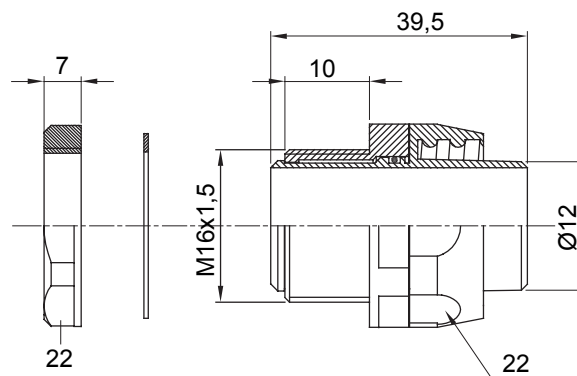

### TECHNICAL SYMBOLOGY

**IP**

IP54

### STANDARDS/APPROVALS

