



HF-Performer Intelligent for TL5 HE/HO lamps

HF-Performer Intelligent 1 28/35/49/54 TL5 EII 220-240V

HF-Performer Intelligent for Master and ECO TL5 HE/HO, TL-D and PL-L lamps HF-Performer Intelligent features automatic recognition of the connected lamp and is independently able to adjust its operation parameters exactly to the respective lamp. This results in a substantial benefit, especially for T5 lamps, as it means TL5 HE and HO lamps of the same length can be interchanged. With a choice of seven ballasts, the customer is able to handle efficiently every possible combination of Master TL5 and Eco, TL-D, and PL-L lamps.

Product data

• General Information

Application Code	EII
Type Version	mk1
Lamp Type	TL5
Number Of Lamps	1 piece/unit
Number Of Products	18
On MCB (16A Type B) (Nom)	
Automatic Restart	Yes

• Operating and Electrical

Input Voltage	220 to 240 V
Input Frequency	50-60_1 Hz
Ignition Method	Warm Start
Crestfactor (Max)	1.7
Ignition Time (Max)	5.0 s
Mains Voltage	-8%+6%
Performance (AC)	
Mains Voltage Safety (AC)	-10%+10%
Earth Leakage Current (Max)	0.5 mA
Inrush Current	0.35 ms
Width	
Constant Wattage Deviation	-2%/+2%
Ballast Factor (Nom)	1.00
Power Losses (Nom)	4.8-7.0 W
Inrush Current Peak (Max)	20 A

• Wiring

Connector Type	Insert
Input Terminals	

Cable Capacity	70 pF
Output Wires Mutual (Nom)	
Connector Type	Insert
Output Terminals	
Cable Length Hot	0.75 m
Wiring	
Wire Striplength	8.0-9.0 mm
Input Terminal Cross Section	0.50-1.00 mm ²
Output Terminal Cross Section	0.50-1.00 mm ²
Cable Capacity	70 pF
Output Wires To Earth (Nom)	

• System characteristics

Rated Ballast-Lamp Power	28-54 W
Rated Lamp Power On TL5	28/35/49/54 W
System Power On TL5	37.9/44.4/56.8/62.6 W
Lamp Power On TL5	30.9/39.8/52.6/57.8 W
Power Loss On TL5	7/4.6/4.2/4.8 W

• Temperature

T-Ambient (Max)	50 °C
T-Ambient (Min)	-25 °C
T-Storage (Max)	80 °C
T-Storage (Min)	-40 °C
T-Case Lifetime (Nom)	75 °C
T-Case Maximum (Max)	75 °C

PHILIPS

HF-Performer Intelligent for TL5 HE/HO lamps

T-Ignition (Max) 50 °C
T-Ignition (Min) -25 °C

Mechanical and Housing

Housing L360x30x22

Emergency Operation

Battery Voltage Lamp Operation 198-276

Approval and Application

Energy Efficiency Index A2
EMI 9 kHz ... 30 MHz EN55015
EMI 30 MHz ... 1000 MHz EN 55022 Class B
Safety Standard IEC 61347-2-3
Performance Standard IEC 60929
Quality Standard ISO 9000:2000
Environmental Standard ISO 14001
Harmonic Current Emission Standard IEC 61000-3-2

EMC Immunity Standard IEC 61547
Vibration Standard IEC 68-2-6 Fc
Bumps Standard IEC 68-2-29 Eb
Humidity Standard EN 61347-2-3 clause 11
Temperature Marking Yes
Emergency Standard IEC 60598-2-22
Hum And Noise Level Inaudible

Product Data

Full product code 871150091496530
Order product name HF-Performer Intelligent 1 28/35/49/54 TL5 EII 220-240V
EAN/UPC - Product 8711500914965
Order code 913700624166
Numerator - Quantity Per Pack 1
Numerator - Packs per outer box 12
Material Nr. (12NC) 913700624166
Net Weight (Piece) 0.247 kg

Dimensional drawing

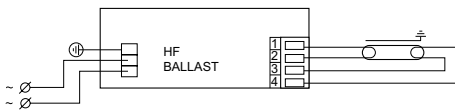
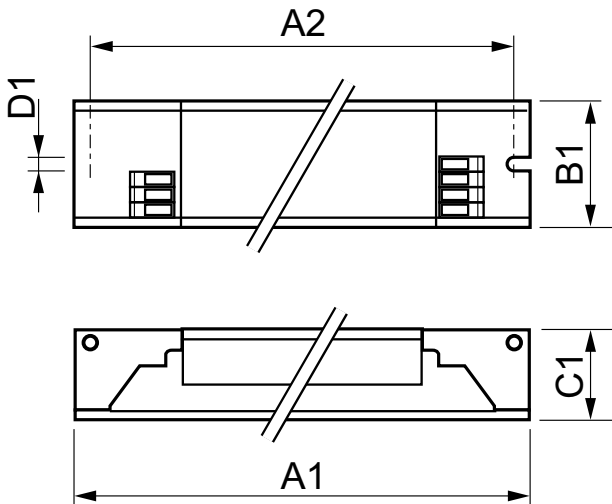

HF-Pi 1 28/35/49/54 TL5 EII 220-240V

Product	D1	C1	A1	A2	B1
HF-Performer Intelligent 1 28/35/49/54 TL5 EII 220-240V	4.2 mm	22 mm	360 mm	350 mm	30 mm

Photometric data

Ballast type	Lamp type	Lamp power	T _a = 40°C	T _a = 50°C	T _a = 60°C	Remarks T _a max = 62°C
			T _c	T _c	T _c	
HF-Pi 1 28/35/49/54 TL5 EII 220-240V	TL5 HE	28W				
	TL5 HE	35W				
	TL5 HO	49W				
	TL5 HE ECO	25W	+54°C	+63°C	+73°C	75°C
	TL5 HE ECO	32W				88,000 Hrs
	TL5 HO ECO	45W				
	TL5 HO ECO	55W				
	TL-D	58W				
	TL5 HO	58W	T _a = 40°C	T _a = 50°C	T _a = 60°C	Remarks T _a max = 58°C
	TL5 HO	58W	T _c	+56°C	+66°C	x
PL-L	55W	Lifetime	100,000 Hrs	100,000 Hrs	x	71,000 Hrs
TL5-C	60W					



© 2015 Philips Lighting Holding B.V.
All rights reserved.

Specifications are subject to change without notice. Trademarks are the property of Koninklijke Philips N.V. (Royal Philips) or their respective owners.

www.philips.com/lighting

2015, December 23
data subject to change